

立式冷藏柜爆炸图 RT-235L(R134a)

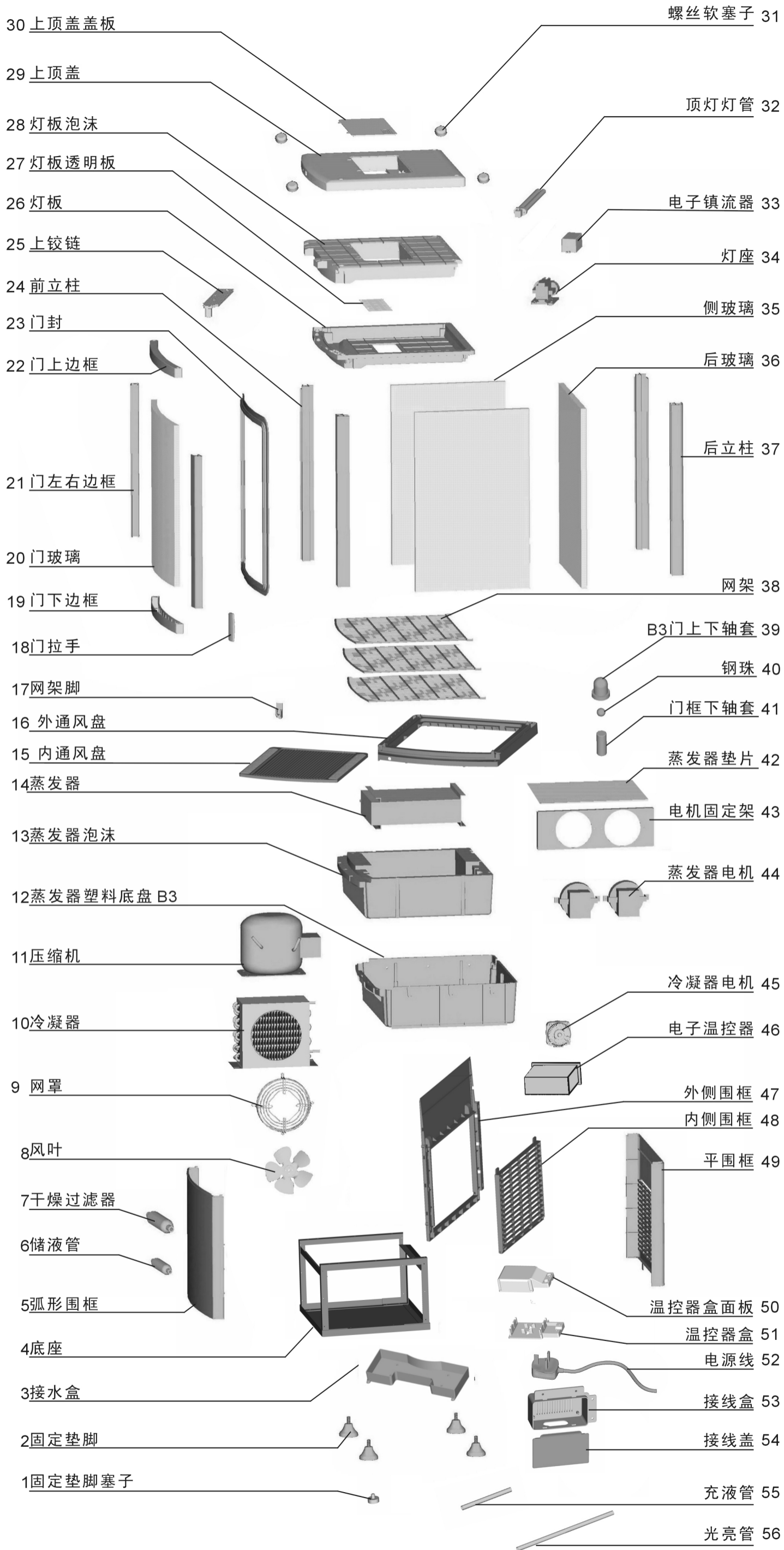

56	1.1.B.B06.21	Connected tube	1.70
55	1.1.B.B06.26	gas tube	0.70
54	1.1.C.C42.03	Control panel	0.30
53	1.1.C.C42.02	Control box	0.50
52	1.1.A.A08.02.78	Power cord	2.86
51	1.1.C.C21.02	Ciruulit board box	0.28
50	1.1.C.C22.04	Box cover	0.16
49	1.1.C.C15.01.05	rear grill	3.90
48	1.1.C.C.15.03.09	Inner Enclosure frame	3.50
47	1.1.C.C.15.03.08	Outer Enclosure frame	3.50
46	1.1.A.A06.03.02	Digital controller	8.80
45	1.1.A.A03.03.01	Motor of condenser	8.10
44	1.1.A.A03.02.04	motor of evaporator	5.20
43	1.1.C.C04.06	motor fixer	0.80
42	1.1.C.C40.02	Cushion of evaporator	0.30
41	1.1.B.B09.03	Door pin	0.10
40	1.1.B.B04.24.02	Steel ball	0.60
39	1.1.C.C13.01	Door shaft	0.10
38	1.1.B.B02.04.01	Shelf	3.60
37	1.1.C.C38.59	Rear pole	6.50
36	1.1.E.E2.01.33	Rear glass	22.10
35	1.1.E.E2.01.32	Side glass	16.30
34	1.1.A.A01.01.03	lamp holder	1.30
33	1.1.A.A01.02.01	Ballast	1.70
32	1.1.A.A01.01.01	Light tube	1.90
31	1.1.C.C03.01	screw cover	0.10
30	1.1.C.C02.01	Outer light cover	1.10
29	1.1.C.C01.13	Outer plastic panel	5.70
28	1.1.D.D08.03.05	foam of light ceiling	1.00
27	1.1.C.C09.01	transparent light ceiling	0.50
26	1.1.C.C05.15	light ceiling	5.00
25	1.1.B.B09.02	upper gemel	0.20
24	1.1.C.C38.58	Front poles of shelves	6.50
23	1.1.E.E1.13	door hinge	5.70
22	1.1.C.C11.13	upper door frame	1.20
21	1.1.C.C38.57	left & right door frame	6.50
20	1.1.E.E2.02.31	Door glass	15.40
19	1.1.C.C11.14	bottom door frame	1.20
18	1.1.C.C12.06	door handle	0.10
17	1.1.C.C10.09	shelf clip	0.10
16	1.1.C.C14.15	Inner ventilated tray	3.60
15	1.1.C.C14.16	Outer ventilated tray	3.60
14	1.1.A.A10.05	evaporator	24.10
13	1.1.D.D08.02.13	foam base for evaporator	2.30
12	1.1.C.C18.03	Plastic base of evaporator	18.90
11	1.1.A.A02.06	Compressor	72.80
10	1.1.A.A09.20	Condenser	17.80
9	1.1.A.A03.04	fan cover	1.60
8	1.1.A.A03.07	fan blade of condenser	0.50
7	1.1.A.A04.06	Dry filter	1.20
6	1.1.B.B06.06	Accumulator	2.60
5	1.1.C.C15.03.03	Curved front base panel	3.50
4	1.1.B.B10.03.01	Base	20.80
3	1.1.C.C29.02	Water receiver	1.50
2	1.1.C.C37.02	Base feet	0.30
1	1.1.C.C41.06	Fixed stopple	0.30
序号	物料代码	名称	单价